



ATX Midi Tower



ECA3250-BW



ECA3250-B



ECA3253-WB

Features

Ostrog – The fortress for your hardware

Solid case for office workstations and gaming PC. Plain and timeless design, refined black front panel with stylish mesh frame in different colours. Black coated interior.

Eye Catcher (only ECA3253-WB)

Acrylic window to attract envious eyes on high-performance hardware and stylish configurations. With two 12cm fan slots.

Professional Cooling System

Outstanding cooling performance for a case of the entry-class: Supports up to seven fans. A 12cm front fan, a 12cm rear fan (pre-installed), two 12/14cm side fans, two 12/14cm top fans and a 12cm bottom fan.

Ultra High-speed Data Transfer

USB 3.0 interface on the top panel for a lightning-fast data transfer with up to 5 Gb/sec. Connected via internal 19 pin connector.

SSD ready!

Shipped with 3.5"-to-2.5"-adapter for easy 2.5" SSD or HDD installation.

Easy Accessible Top Interfaces

With 1x USB 3.0, 3x USB 2.0 and audio I/O.

Full Gaming Power

Removable hard disk cage to support longer high-end graphic cards with up to 413mm length.

No more tangled cables

Cutouts for a hidden and clean cable management. Plenty room for an efficient cable routing behind the mainboard tray.

Quick and User-friendly System Installation

Screwless quick release fasteners for HDD and ODD, thumb screws for side panels and cut out for comfortable CPU cooler montage.

Bottom-mounted PSU

Comfortable cable routing and optimized cooling performance thanks to bottom-mounted power supply. With anti-vibration rubber pads and cleanable dust filter at the bottom of the case.

Liquid Cooling

Two water cooling holes with rubber grommets at the back of the case.



Tool-less design for easy installation



Top I/O and device tray for quick access

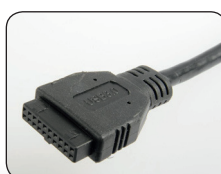

Internal USB3.0 support



CPU Cooler support up to 174 mm



Removable HDD cage

VGA Card Support



Removable hard disk cage to support longer high-end graphic cards with up to 413mm length.

Cooling System

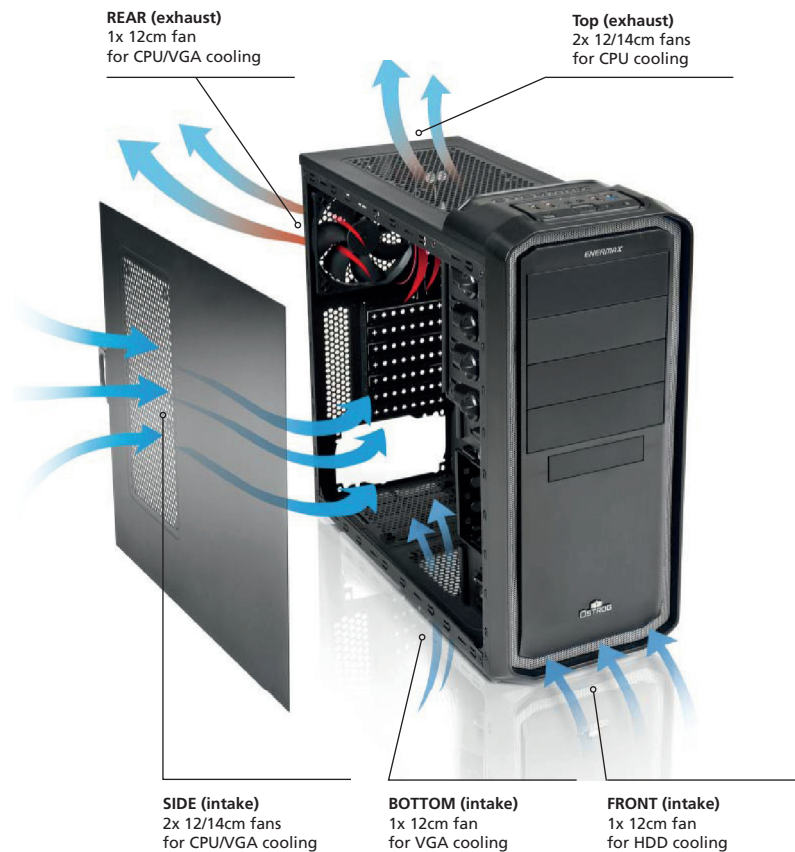

Specifications

Model		ECA3250-B/-BW	ECA3253-WB
Type		ATX Midi Tower	
Colour		Black / Black-White	White-Black
Interior		Black	White
Dimensions (D x W x H)		480mm x 200mm x 460mm	
Material		0.6mm SGCC	
Drive bays	5.25"	4	
	3.5"	1x external / 5x internal	
	2.5"	1x 3.5" -to-2.5" adapter	
M/B		ATX & Micro ATX	
Front I/O		1x USB 3.0, 3x USB 2.0, HD/AC'97 Audio	
Air cooling	Front	1x 12cm fan (optional)	
	Rear	1x 12cm fan (pre-installed)	
	Top	2x 12/14cm fans (optional)	
	Side	2x 12/14cm fans (optional)	
	Bottom	1x 12cm fan (optional)	
Expansion slots		7	
Liquid cooling holes		2	
Certifications & Standards		  	